

Wheel Features

Tread Material:	TPR	Core Material:	High Strength PP
Bearing:	Single Ball Bearing	Tread Hardness:	85A±3
Temperature:	-15°C~60°C	Running Speed:	3.2km/h

Note: Use beyond temperature range or beyond the recommended speed may shorten product life or even damage the product.





- ✔ Precision ball bearing, flexible rotation
- ✔ Advanced thermo-plastic rubber, silent running, elastic to protect floor
- ✔ Environmental protection, quiet, effectively protect the floor
- ✔ With plastic covers, thread-proof design
- ⚠ Economical material with common load capacity



Rolling resistance	■ ■ ■ □ □	Good
Wear resistance	■ ■ ■ □ □	Good
Operating noise	■ ■ ■ ■ ■	Excellent
Floor surface preservation	■ ■ ■ ■ ■	Excellent

Bracket Features

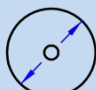
- ✔ Easy to operate, convenient to release the brake
- ✔ 304 Stainless Steel material pressed, anti-rust and anti-corrosion
- ✔ Polishing treatment, excellent appearance

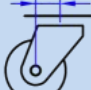
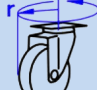
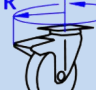
Parameter (mm)							
Wheel Size	Capacity	Wheel Dia.	Wheel Width	Total Height	Offset	Swivel Radius	Swivel Radius
1.5"	30 kg	40	20	60	25	45	67
2"	50 kg	50	22	70	23	48	67

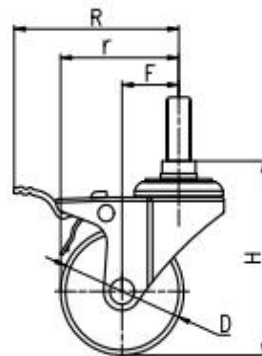
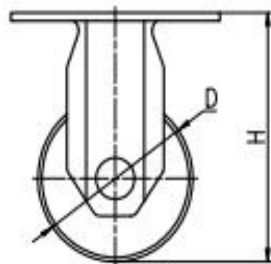
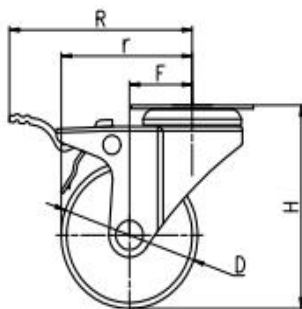

Mounting Drawing

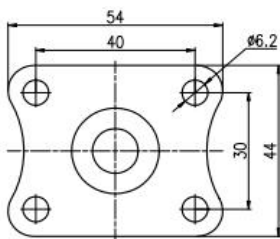

Plate Swivel/Brake

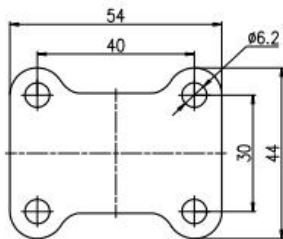
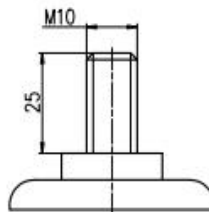







Plate Fixed



Threaded Stem

Product ID					
Wheel Size	Plate swivel	Plate fixed	Plate swivel brake	Threaded stem	Threaded stem brake
1.5"	10D01-1631	10D02-1631	10D03-1631	10D04-1631	10D05-1631
2"	10D06-1632	10D07-1632	10D08-1632	10D09-1632	10D10-1632

Product Details



Electrolytic polishing, appearance is beautiful and simple.

Concave and convex dustproof cover, anti-winding.



Double steel bowl design, stable structure, flexible rotation.

