

Wheel Features

Tread Material:	Rubber	Core Material:	Nylon
Bearing:	Ball Bearing	Tread Hardness:	75A±3
Temperature:	-20°C~50°C	Running Speed:	4km/h

Note: Use beyond temperature range or beyond the recommended speed may shorten product life or even damage the product.



- ✔ 2 precision ball bearings,flexible rotation
- ✔ Natural rubber material,injection bonding molding,high rebound
- ✔ Environmental protection,quiet,effectively protect the floor
- ✔ With plastic covers,thread-proof design
- ⚠ Biodegradable rubber material,recommended to use within 3 year of production for best performance



Rolling resistance	■ ■ ■ ■ □	Very good
Wear resistance	■ ■ ■ ■ □	Very good
Operating noise	■ ■ ■ ■ ■	Excellent
Floor surface preservation	■ ■ ■ ■ ■	Excellent

Bracket Features

- ✔ Stable braking effect
- ✔ Spindle equipped with precision bearing,quiet and flexible
- ✔ Bracket made of pressed steel plate,firm and strong
- ✔ No-swing design:caster stops swing immediately after being held horizontally
- ✔ Powder spray treatment,superior anti-rust and anti-corrosion performance,salt spray test over 72 hours
- ⚠ Wheel brake only,without direction lock function

Parameter (mm)							
Wheel Size	Capacity	Wheel Dia.	Wheel Width	Total Height	Offset	Swivel Radius	Swivel Radius
5"	120 kg	125	38	168	35	97.5	126
6"	140 kg	150	38	195	35	110	126

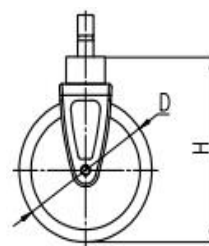
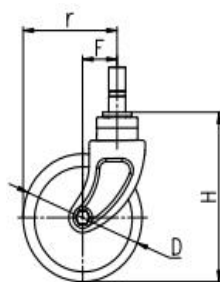
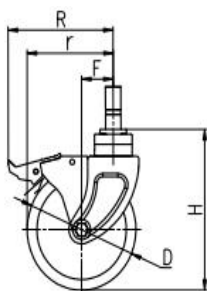

Mounting Drawing

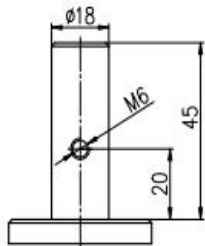

Product ID			
Product Images			
Wheel Size	Plate swivel	Plate fixed	Plate swivel brake
5"	25D03-1317	25D01-1317	25D02-1317
6"	25D06-1318	25D04-1318	25D05-1318

Product Details



Double bearing swivel structure, quiet and flexible.

Anti-waggle design while caster is put down, and ensure smooth rotation in the vertical state.

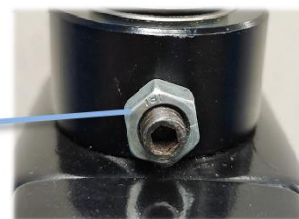

Electrophoretic scaffolds have better anticorrosion performance.



Dust cover can effectively protect the bearing and Anit-winding.

