

Wheel Features

Tread Material:	Nylon	Core Material:	Nylon
Bearing:	Ball Bearing	Tread Hardness:	75D±3
Temperature:	-30°C~90°C	Running Speed:	4km/h

Note: Use beyond temperature range or beyond the recommended speed may shorten product life or even damage the product.







- ✔ 2 precision ball bearings,flexible rotation
- ✔ Injection nylon with glass fiber,high load capacity,high wear resistance
- ✔ No deformation,anti-aging,endurable to humid environment
- ⚠ Hard wheel material,it may damage epoxy flooring
- ⚠ Wheel running may cause some noise

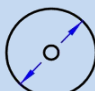
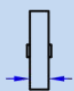

Rolling resistance	■ ■ ■ ■ ■	Excellent
Wear resistance	■ ■ ■ ■ ■	Excellent
Operating noise	■ ■ □ □ □	Acceptable
Floor surface preservation	■ ■ □ □ □	Acceptable

Bracket Features

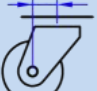
- ✔ Stable braking effect
- ✔ Bracket made of pressed steel plate,firm and strong
- ✔ Reinforced riveted,close gap,high structural strength
- ✔ Electrophoretic treatment,salt spray test over 72 hours
- ⚠ Wheel brake only,without direction lock function

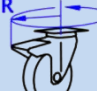
Parameter (mm)							
Wheel Size	Capacity	Wheel Dia.	Wheel Width	Total Height	Offset	Swivel Radius	Swivel Radius
2.5"	450 kg	65	46	90	24	62.5	95
3"	500 kg	75	46	100	25	67.5	95

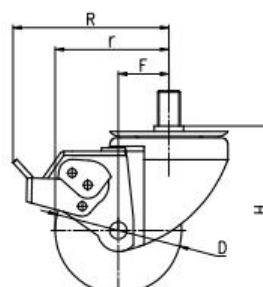
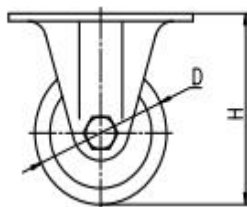
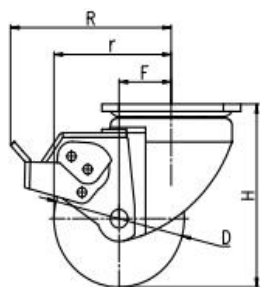

Mounting Drawing

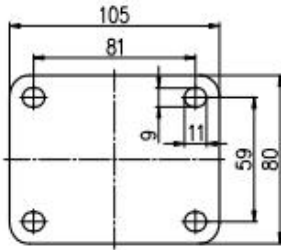

Plate Swivel/Brake

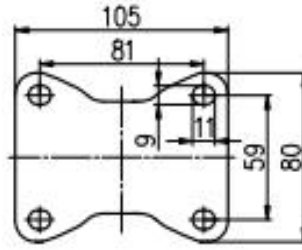
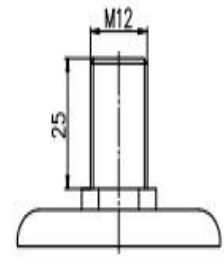

Plate Fixed



Threaded Stem

Product ID					
Product Images					
Wheel Size	Plate swivel	Plate fixed	Plate swivel brake	Threaded stem	Threaded stem brake
2.5"	30A22-1314	30A03-1314	30A23-1314	30A24-1314	30A25-1314
3"	30A26-1315	30A08-1315	30A27-1315	30A28-1315	30A29-1315

Product Details

Rear brake is more stable and easy to operate for high loading capacity.



Double steel bowl design, stable structure, flexible rotation. Dust ring can effectively protect dust and grease lubrication.



Double ball precision bearing with high loading capacity and low resistance.

