

Wheel Features

Tread Material:	PU	Core Material:	Cast Iron
Bearing:	Ball Bearing	Tread Hardness:	95A±3
Temperature:	-25°C~60°C	Running Speed:	4km/h

Note: Use beyond temperature range or beyond the recommended speed may shorten product life or even damage the product.







- ✔ 2 precision ball bearings,flexible rotation
- ✔ Polyurethane on casting iron core,high load capacity,wear resistance,oil resistance
- ✔ Environmental protection,quiet,effectively protect the floor
- ✔ With iron covers,thread-proof design
- ✔ Painted,anti-rust and anti-corrosion
- ⚠ High temperature and humidity may shortened service life

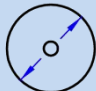
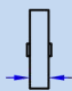

Rolling resistance	■ ■ ■ ■ □	Very good
Wear resistance	■ ■ ■ ■ ■	Excellent
Operating noise	■ ■ ■ ■ □	Very good
Floor surface preservation	■ ■ ■ ■ □	Very good

Bracket Features

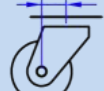
- ✔ ON/OFF pedals,stable braking effect,easy to operate
- ✔ Steel plate pressed and fully welded,firm and strong
- ✔ Dustproof ring effectively protects grease for long sevice life
- ✔ Double springs plus cushion block design,outstanding shock absorption performance
- ✔ Powder spray treatment,superior anti-rust and anti-corrosion performance,salt spray test over 72 hours
- ⚠ Wheel brake only,without direction lock function

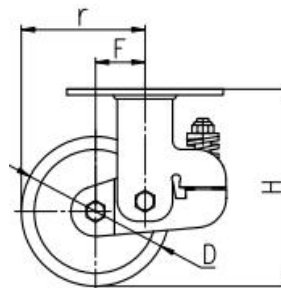
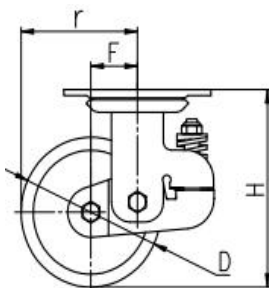

Parameter (mm)							
Wheel Size	Capacity	Wheel Dia.	Wheel Width	Total Height	Offset	Swivel Radius	Swivel Radius
5"	360 kg	125	48	185	50	112.5	175
6"	440 kg	150	50	197	50	125	183
8"	550 kg	200	50	247	63	163	190

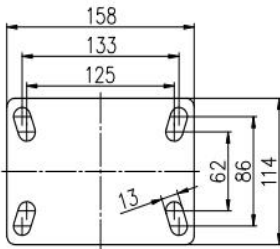

[English]

Mounting Drawing



Product ID	Product Images	Wheel Size	Plate swivel	Plate fixed	Plate swivel brake
		5"	45A01-0129	45A02-0129	45A19-0129
		6"	45A03-0130	45A04-0130	45A20-0130
		8"	45A05-0131	45A06-0131	45A21-0131

Product Details

ON/OFF brake is easy to operate.

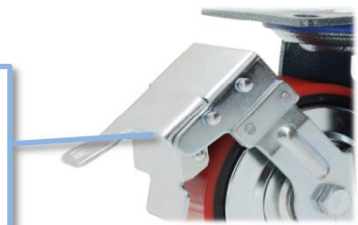

Double spring damping performance is superior, can effectively buffer, ensure balance and stability.

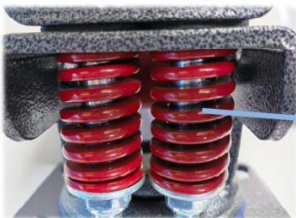

Double-welded, strong and robust. Dust ring can effectively protect the dust and grease lubrication.

